

## Instruction Manual

# HAAN®

EXPERIENCE STEAM. DISCOVER CLEAN.™

*name:* **Total**

*model number:* **HD-60**

*“Steam. Sweep. Sanitize. One  
step cleaning.”*

**HAAN® Corporation**  
1866 Colonial Village Lane  
Lancaster, PA 17601

**phone: 877-422-6347**

**[www.HAANusa.com](http://www.HAANusa.com)**



## **Notice**

The information contained in this document is subject to change without notice.

**HAAN®** Corporation assumes no responsibility for any errors that may appear in this document nor does it make expressed or implied warranty of any kind with regard to this material, including, but not limited to, the implied warranties of merchantability and fitness for a particular purpose.

**HAAN®** Corporation shall not be liable for incidental or consequential damages in connection with or arising out of the furnishing, performance, or use of this document and the program materials which it describes.

All rights reserved. No part of this document may be photocopied, reproduced or translated to another language without prior written consent of **HAAN®** Corporation.

**HAAN®** is a registered trademark of the **HAAN®** Corporation.

**HAAN®** Experience Steam. Discover Clean.™  
is a trademark of the **HAAN®** Corporation.

# Introduction

Congratulations on purchasing a **HAAN®** product. Now you have an easy way to clean your tile, hardwood, laminate, linoleum and vinyl floors.

Your floor sanitizer uses steam to remove tough grease, dirt and grime. Steam is nature's purest and most powerful cleaner for safely cleaning all hard surfaces in your home without harsh chemicals, for a perfectly ecological approach. No film, no residue – just clean, germ-free floors.

**HAAN®** products are so easy to assemble, you can put them to use right away – anywhere you want to clean and sanitize – from your kitchen and living room to your bathroom floors.

Backed with a one-year limited warranty, your quality **HAAN®** product is sure to give you years of dependability. And our Customer Care representatives are available to answer any of your questions about your new floor sanitizer.

Thousands of **HAAN®** customers have already fallen in love with **HAAN®** Floor Sanitizers. We're confident you will, too.

Thank you again for purchasing the **HAAN®** Total Floor Sanitizing Steam Mop and Sweeper.

*The **HAAN®** Team*

# Important Safety Instructions

**Basic precautions should be observed when using an electrical appliance, including the following:**

## **IMPORTANT**

Be sure to read ALL instructions and warnings before using your **HAAN®** Floor Sanitizer.



## **WARNING**

**Risk of electrical shock: Be sure to read and follow all instructions and warnings.**



## **CAUTION**

**The HD-60 emits steam at 212°F to sanitize the area of use. This means that the steam head, Ultra-Microfiber Pads and Carpet Glide get very hot during use. Care should be taken when using this appliance. DO NOT touch them during use except in the approved manner as outlined in this manual.**

## **SAVE THESE INSTRUCTIONS:**

For household use only. Any other use of this appliance will void the manufacturer's warranty.

1. Do not direct steam at people, animals, or at electrical outlets.
2. Do not expose to rain.
3. Store indoors.
4. Unplug from outlet when not in use and before conducting service maintenance or trouble-shooting.
5. Do not leave steam cleaner unattended.
6. Do not leave the steam cleaner connected to an electrical outlet when not in use.
7. Do not service steam cleaner when it is plugged in.
8. Do not use with damaged cord or plug.
9. Do not use steam cleaner if it has been dropped, damaged, left outdoors or dropped into water. Return to a service center.
10. Do not handle steam cleaner with wet hands.
11. Do not pull or carry by cord, use cord as a handle, close door on cord, pull cord around sharp corners or expose cord to heated surfaces.
12. Do not unplug by pulling on cord.
13. Do not use appliance in an enclosed space filled with vapor given off by oil-base paint thinner, some moth-proofing substances, flammable dust, or other explosive or toxic vapors.
14. Do not allow to be used as a toy.
15. Do not use on leather, wax polished furniture or floors, synthetic fabrics, velvet or other delicate, steam-sensitive materials.
16. Do not immerse in water or any other liquid.
17. Do not use for any purpose other than described in this User Manual.
18. Use only manufacturer's recommended attachments – use of attachments not provided or sold by **HAAN®** may cause fire, electric shock or injury.

## Important Safety Instructions

19. Never put descaling, aromatic, alcoholic or detergent products into the steam cleaner, as this may damage it or make it unsafe for use.
20. Unplug by grasping the plug, not the cord.
21. Close attention is necessary when used by or near children.
22. If the circuit breaker activates while using the steam function, discontinue product use immediately and contact the customer support center. (Beware of the risk of electrical shock.)
23. Do not allow the product to be disassembled and/or modified by anyone other than an authorized service technician. (Doing so can result in fire and/or electrical shock.)
24. Do not puncture steam hose that is exposed by the swivel steam head joint.
25. This product is NOT for space heating purposes.

### IMPORTANT ►



#### **WARNING**

**DO NOT modify the plug. Improper connection can result in a risk of electrical shock.**

### **Electrical Plug Instructions:**

This appliance has a polarized plug (one blade is wider than the other). As a safety feature, this plug will fit in a polarized outlet only one way. If the plug does not fit fully in the outlet, reverse plug. If it still does not fit, contact a qualified electrician. Do not attempt to defeat this safety feature.

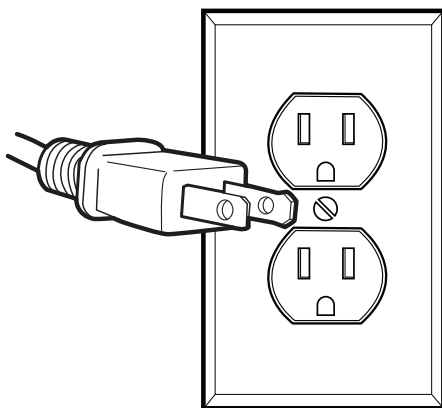

## Care & Maintenance

### IMPORTANT

Always ensure that your floor sanitizer is **UNPLUGGED** from the wall receptacle prior to cleaning or emptying the water tank.



### CAUTION

Do not immerse your floor sanitizer in water or any other liquid.



### CAUTION

Always operate floor sanitizer by gripping the handle. Do not grip by the pole.

1. Turn your floor sanitizer off and unplug from the electrical outlet.
2. Wrap power cord around cord hangers.
3. Let your floor sanitizer cool for five (5) minutes before removing the ultra-microfiber pad and before emptying the water tank.
4. Always empty the water tank when you have finished using your floor sanitizer.
5. Never leave ultra-microfiber pad on floor sanitizer when you have finished using it. Always remove the ultra-microfiber pad and wash in warm water with a mild detergent. Never use bleach or fabric softener when cleaning the ultra-microfiber pad. The ultra-microfiber pad can be washed in a washing machine and dried in a clothes dryer but on low heat. To decrease pad wear, we recommend the pad be hung to dry for 24 hours.
6. Wipe your floor sanitizer with a damp cloth to clean. Never immerse the sanitizer in water or any other liquid.
7. In order to keep your floor sanitizer in good condition, we recommend that you clean the water tank once a month to eliminate calcium deposits. Add eight ounces (8 oz) of water to the water tank and insert 1 packet of Fresh Rinse™ Lime and Scale Remover. Shake to loosen any deposits. Place unit on resting mat without pad, turn unit on and allow water to steam until water in tank is depleted. **Do not use vinegar or other decalcifying substances in the floor sanitizer water tank.**

---

## Helpful Hints

1. Occasionally remove brush roll to clean out any debris caught within the bristles.
2. The easiest way to use the machine is to tilt the handle to a 45° angle and clean slowly 2-3 yards at a time.

## Helpful Hints Cont.

3. A good amount of steam passes through the ultra-microfiber pad. We recommend that the ultra-microfiber pad be changed when it becomes oversaturated.
4. To remove stubborn stains from vinyl or linoleum floors, pre-treat with a mild detergent and some water before using the floor sanitizer.

### Ultra-Microfiber Pads for HAAN® Floor Sanitizing Steam Mop

#### What is an ultra-microfiber?

An ultra-microfiber is a textile fiber that is thinner and more absorbent than a micro-fiber (1.0dtex) pad typically used with steam mops. Specifically, to be defined as an ultra-microfiber, it should be less than 0.2dtex. The Ultra-Microfiber pad by HAAN® Corporation is made of .17dtex ultra-microfibers.

#### How to Use Ultra-Microfiber Pads

1. Please make sure that a completely dry pad is used.
2. As high temperature steam passes through a pad to contact the floor to kill germs, molds, mites and to provide a certain amount of water necessary for cleaning, it is natural that the pad gradually absorbs moisture. After a certain length of time, the pad repels water and becomes damp.
3. To keep the floor clean and dry, replace the pad when it is dirty.
4. Only remove pad from unit when not in use and steam is not being emitted.

#### How to Clean and Store

1. Hand wash or machine wash the ultra-microfiber pad in cold water on the delicate cycle with a mild detergent. (Do not use a fabric softener)
2. Using a washing machine may shorten the lifespan of the pads.
3. We recommend air drying the ultra-microfiber pad for 24 hours, but they could be dried in a dryer on a low heat setting.

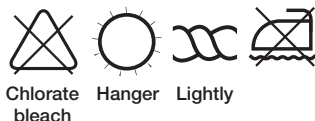

## Product Assembly & Parts

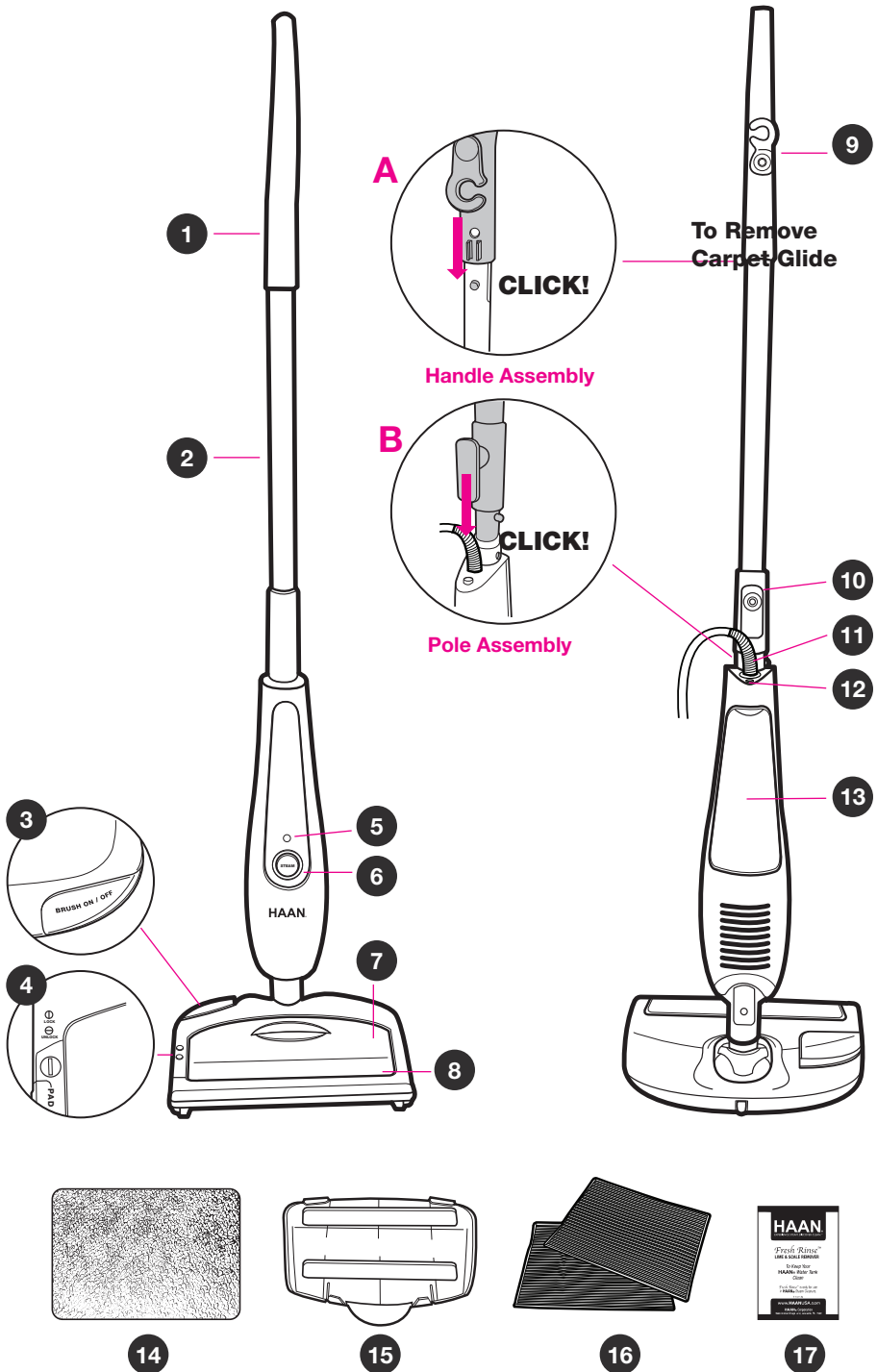



1. Handle
2. Pole
3. Sweeper Brush ON/OFF
4. Sweeper Brush LOCK/UNLOCK
5. Power Indicator Light
6. Steam Power Switch
7. Sweeper Collection Bin
8. Sweeper Brush
9. Storage Hook (rotates 360°)
10. Power Cord Organizer (bottom)
11. Power Cord
12. Water Tank Release Button
13. Detachable Water Tank
14. Floor Protector / Resting Mat
15. Carpet Glide
16. Ultra-Microfiber Pads (x2)
17. Fresh Rinse Lime & Scale Remover (x12)

### Helpful Hint:

To extend the life of your Ultra-Microfiber Pads, always place your unit on the floor protector/resting mat while the unit heats up. Attach the Ultra-Microfiber pad when the unit is ready to use.

### Helpful Hint:

When using the Floor Sanitizer with the Carpet Glide it will not lift all set-in stains from your carpet. Our patented Ultra-microfiber pad may be used to act as a “blotter” for removing most fresh, wet spills and stains.

## Before Using Your Floor Sanitizer

Be sure to read **ALL** instructions and warnings *before* using your Floor Sanitizer.



### WARNING

Your floor sanitizer is designed to clean hard floor surfaces that will withstand high heat. Do not use on unsealed wood or unglazed ceramic floors. On surfaces that have been treated with wax or some no-wax floors, the sheen may be removed by the heat and steam action. It is always recommended to test an isolated area of the surface to be cleaned before proceeding. We also recommend that you check the use and care instructions from the floor manufacturer.

### Helpful Hint:

When heated, never leave the appliance in one spot on any surface for any period of time. Always place your Floor Sanitizer on the Floor Protector/Resting Mat when stationary.

### Helpful Hint:

Always empty water from water tank after use. To ensure optimum product function use Fresh Rinse™ once a month.

## Before Using Your Floor Sanitizer cont.



### CAUTION

Use only a heavy duty extension cord rated for 15 amps minimum – **DO NOT** use an ordinary extension cord.

### IMPORTANT

This product is **NOT** for space heating purposes.



### CAUTION

HAAN® floor care products emit steam at 212° to sanitize the area of use. This means that the steam head, Ultra-microfiber pads and carpet glide get very hot during use. Care should be taken when using this appliance and **DO NOT** touch components of this machine during use except in the approved manner as outlined in this manual.

## Using the Steam Function - Operating Instructions

1

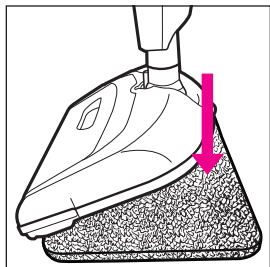

Assemble unit and place on Floor Protector / Resting Mat.

2

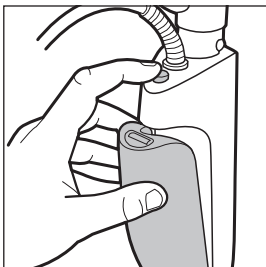

Press Water Tank Release button and remove water tank.

3

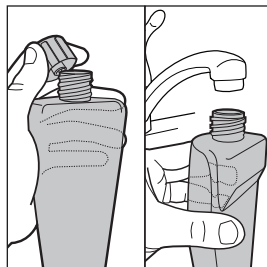

Turn Cap counterclockwise to Remove. Fill tank with water.

4

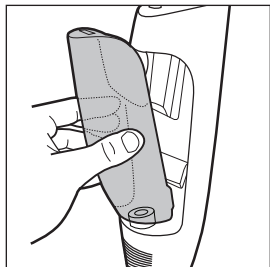

Tighten cap. Insert tank (cap down) until it “clicks”.

5



Press ON/OFF button. Wait 20 seconds for unit to heat up. Unit may vibrate while heating.

6

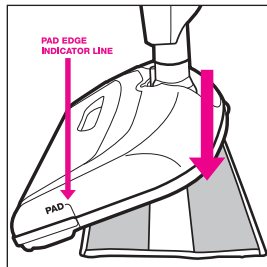

Line up edge of Pad with PAD EDGE INDICATOR LINE. Gently place unit on Ultra-microfiber pad. You are now ready to steam clean.

7

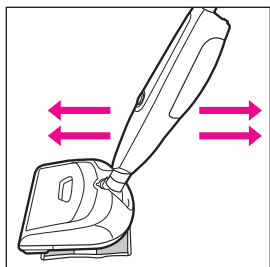

Tilt handle at a 45° angle. Push and pull slowly across the floor to clean thoroughly.

8



When done, push ON/OFF button.

9

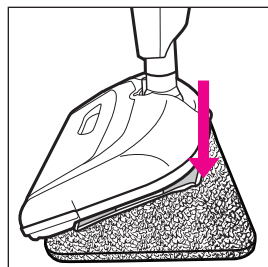

Place unit with Ultra-microfiber pad attached onto Floor Protector / Resting Mat. Allow to cool down for five (5) min.

10

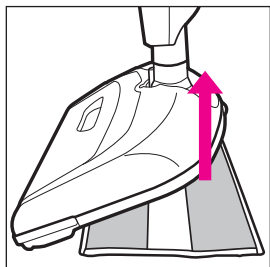

When unit has cooled, remove Ultra-microfiber pad. Store unit upright in a dry area.



### **IMPORTANT: Vibration Sound**

While the unit is turned off, air builds up in the water pump line. This is a common occurrence. When the unit is turned on the water pump pushes air out of the line and emits a vibrating sound. This occurs while the unit is heating up and also when the water tank is emptied during use. If the vibration sound persists for more than 60 seconds during heat up, check to make sure the water tank is assembled correctly.

### **IMPORTANT**

Always empty the water tank once you have finished using your Floor Sanitizer.

## **Using the Sweeper Function**

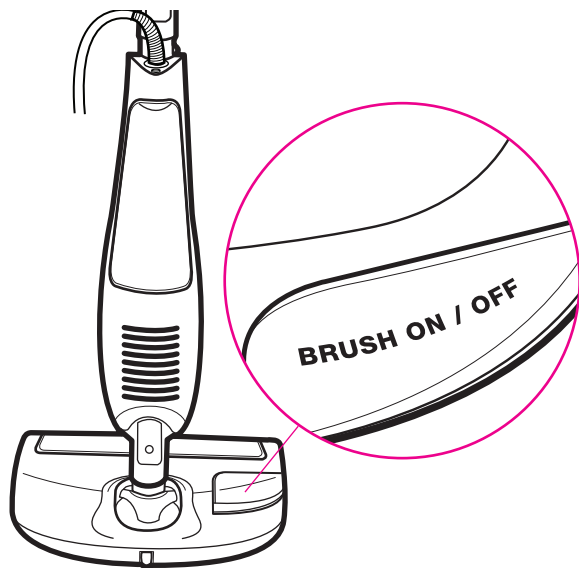

To turn Sweeper Brush ON/OFF, gently press the "Brush ON/OFF" button located on the back of the unit.

### **Helpful Hint:**

When cleaning floors the steam function and sweeper function can be used at the same time.

## Using the Carpet Glide

### What is the Carpet Glide?

For use with high pile carpeting. The carpet glide enables the Floor Sanitizer to freshen, deodorize and sanitize carpeting, rugs, upholstery, pet cushions and more. Used with the Floor Sanitizer it kills dust mites and other allergens on a variety of surfaces. It also makes transitioning from hard floors to carpets & rugs easy.

**NOTE:** The Carpet Glide is used **WITHOUT** the Ultra-Microfiber Pad.

1

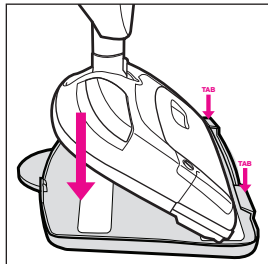

Attach carpet glide by placing unit under "tabs" and gently pushing down into place.

2



With carpet glide attached, place on Floor Protector / Resting Mat. Turn unit ON and follow operating instructions to clean.

3

### To Remove Carpet Glide

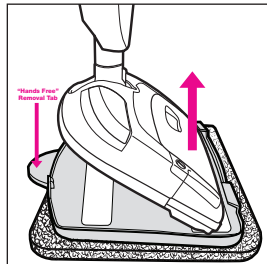

Turn unit OFF, let cool. Use foot on "Hands Free" tab to remove Tray from steam head.

## Using the Carpet Glide - FOR FRESH STAINS

1

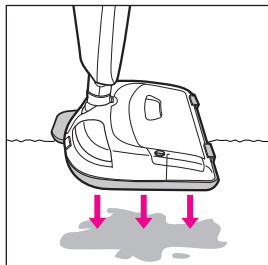

Place unit on stain. Let stand for a few seconds. Allow steam to saturate stain.

2

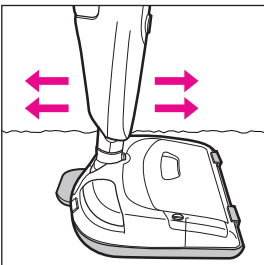

Slowly move unit back and forth over stain.

3

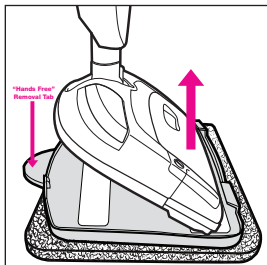

Remove carpet glide from unit with hands free tab.

4

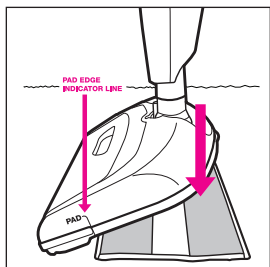

Line up edge of Pad with PAD EDGE INDICATOR LINE. Gently place unit on Ultra-microfiber pad.

5

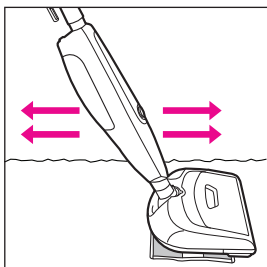

Use the pad to rub the area "blotting" out the stain.

6

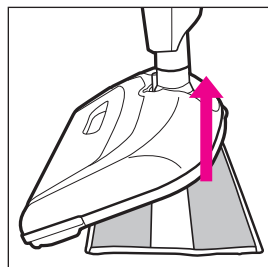

Turn unit OFF. When cooled, remove Ultra-microfiber pad.

## Removing the Sweeper Collection Bin & Brush

1

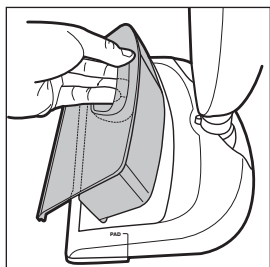

Gripping the handle, lift collection bin from unit.

2

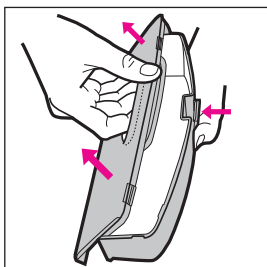

Press the collection bin release button, lift & tilt top to open. Empty collection bin.

3

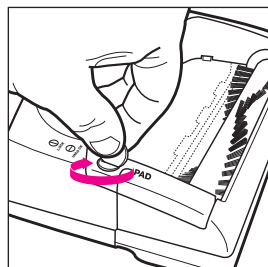

Using a dime, turning clockwise, unlock the brush UNLOCK/LOCK button.

4

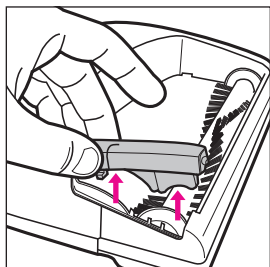

Remove the brush lock piece.

5

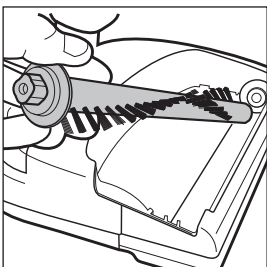

Remove brush from unit and clean.

# Troubleshooting

Problem	Solution
Vibration sound last longer than 60 seconds.	<ul style="list-style-type: none"><li>• Add water to the water tank.</li><li>• Ensure that water tank is inserted correctly in unit.</li></ul>
Unit not operating.	<ul style="list-style-type: none"><li>• Ensure plug is set firmly in outlet.</li><li>• Replace fuse or reset breaker.</li></ul>
Unit does not emit steam.	<ul style="list-style-type: none"><li>• Ensure water tank is filled with water.</li></ul>
Water left on floor.	<ul style="list-style-type: none"><li>• Change the Ultra-microfiber pad.</li><li>• Ensure unit is always level and parallel to the floor.</li></ul>
White spot left on floor.	<ul style="list-style-type: none"><li>• When cleaning do not leave unit in one spot for too long.</li><li>• Use protector pad / floor mat when unit is ON and stationary.</li><li>• Use distilled water instead of hard tap water.</li></ul> <p><b>NOTE:</b> To remove spot, use a damp cloth with a few drops of white vinegar to rub and remove stain.</p>

## Commonly Asked Questions

### **Q: Can the HAAN Floor Sanitizer be used on laminate flooring?**

A: Yes. Your floor sanitizer was designed to be gentle on delicate flooring, yet powerful enough to penetrate stains and kill harmful germs and bacteria.

### **Q: How long can an Ultra-microfiber Pad be used until it needs to be changed?**

A: The pad should be changed every 10 minutes, or when it becomes saturated with water. The unit will become harder to push with an overly wet pad.

### **Q: How long does a tank of water last?**

A: A full tank will last approximately 20-25 minutes.

### **Q: Sometimes my floor sanitizer becomes hard to push - why?**

A: If the unit is hard to push it's likely because the Ultra-microfiber Pad is too wet or the angle at which you are using the machine is too high.

### **Q: How do you use the Carpet Glide for my carpet?**

A: The carpet glide is to be used without the Ultra-microfiber Pad and can be attached directly to the unit.

### **Q: Does the HAAN work on pet stains?**

A: Yes, the HAAN is able to spot clean fresh pet stains by loosening and lifting the stain.

### **Q: How can I prolong the life of my HAAN?**

A: To maintain the life of your unit, we recommend using the Fresh Rinse once a month.

### **Q: Will the Total HD-60 replace my vacuum?**

A: While the Total may not completely replace the need for a full-section vacuum cleaner, using the unit can reduce the frequency of vacuuming.

## **Couldn't find the Answer to your Question?**

**Call Customer Care at 877-HAAN DIRECT / 877-422-6347**

To order additional pads, accessories or replacement parts call customer care at:

**877-HAAN DIRECT / 877-422-6347**

Or visit:

**[www.HAANusa.com](http://www.HAANusa.com)**



Product Specifications: Model HD-60	
Color	Grey and Red
Size	11.02" W x 8.66" D x 49.21" H
Weight	5.91 lb
Voltage/Hz	AC 120V, 60Hz
Wattage	1200 watts
Cord Length	25 Feet
Tank Capacity	11.83 oz.
Heat-up Time	20 sec.
Operating Time	Up to 25 min.
*Dimensions approximated. Dimensions include base and measured without hose, or attachments.	

## One-Year Limited Warranty

Your **HAAN®** Floor Sanitizer is warranted to be free from defects in material and workmanship for a period of one (1) year from the date of purchase when utilized for normal household use by the original purchaser only. The included Warranty Registration Card should be filled out and returned within thirty (30) days of purchase. This will register your product. Should any defect covered by the terms of the limited warranty be discovered within one year, **HAAN®** Corporation will repair or replace the defective part, provided the unit is returned by the original purchaser, freight prepaid, to: **HAAN®** Corporation, 1866 Colonial Village Lane, Lancaster, PA 17601. Proof of purchase is required and should accompany the return.

The liability under this warranty is limited solely to the cost of the replacement parts or the complete unit at our option. Labor charges are not included.

This warranty is extended to the original purchaser of the unit and excludes all other legal and/or conventional warranties. The responsibility of **HAAN®** Corporation, if any, is limited to the specific obligations expressly assumed by it under the terms of the limited warranty. In no event is **HAAN®** Corporation liable for incidental or consequential damages of any nature whatsoever. Some states/provinces do not permit the exclusion or limitation of incidental or consequential damages, so the above may not apply to you. This warranty gives you specific legal rights which vary from state to state or province to province.

IMPORTANT: Before packing be sure to attach a tag to item with your name, complete address, phone number and a note giving purchase information, model number and what you believe to be the problem with the item. Carefully pack item to avoid damage in shipping. To expedite your repair, we request that you call Customer Care to report the problem prior to shipping your product back. We also recommend that you insure the package (as damage in shipping is not covered by our warranty). Mark the outside of your package "ATTENTION CUSTOMER CARE." We are constantly striving to improve our products; therefore, the specifications contained herein are subject to change without notice.

**Warranty Notice: FAILURE TO COMPLETE AND RETURN THE PRODUCT REGISTRATION CARD WILL NOT DIMINISH YOUR WARRANTY RIGHTS.**

# Product Registration

Please fill out and mail this Product Registration Card within thirty (30) days of purchase in order to validate the fore said Limited Warranty. The registration will allow us to contact you in the unlikely event of a product safety notification. By returning this card you acknowledge that you have read and understood the instructions for use and the warnings set forth within the instructions.

First Name	Last Name
Address	
City	State/Province
Zip Code/Postal Code	Country/Territory
Product Name/Model number	
Date Purchased	Place of Purchase

(Fold here and tape closed before mailing)

**Warranty Notice:** FAILURE TO COMPLETE AND RETURN THIS PRODUCT REGISTRATION CARD WILL NOT DIMINISH YOUR WARRANTY RIGHTS.

**Privacy Notice:** We use this information requested on this card to process your registration, thereby allowing you to receive the benefits of being a registered user, and for use in post-sales services. Other uses of your information are governed by the choices you make in answering the questions and the HAAN privacy policy. For information on this policy contact 877- HAAN DIRECT.

1) Yes! I would like HAAN® to send me information on products and services including new product releases, events and special offers. You may contact me by:

EMAIL	<input type="checkbox"/>	_____
PHONE	<input type="checkbox"/>	_____
MAIL	<input type="checkbox"/>	_____

2) What other HAAN® products have you purchased?

_____
_____

Cut along dashed line

**Place  
Stamp  
Here**

**Product Registration  
HAAN<sup>®</sup> Corporation  
1866 Colonial Village Lane  
Lancaster, PA 17601**

3) Where did you purchase your **HAAN<sup>®</sup>** product?

---

---

---

4) How did you hear about **HAAN<sup>®</sup>**?

---

---

---

5) We like to hear from our product owners. Please add any  
comments here:

---

---

---

---

---

---

---